



Overview of Treasure Island and Yerba Buena Island Electricity & Legacy Gas Service

June 10, 2026



San Francisco
Water Power Sewer

Services of the San Francisco Public Utilities Commission



Presentation Overview

- I. TI/YBI Electrical System
- II. TI Legacy Natural Gas System





TI/YBI Electricity System

- 1997: Naval Station Treasure Island closes. City/TIDA and Navy enter into Cooperative Agreement, including operating and maintaining legacy utility infrastructure.
- 2016: New infrastructure construction commences with TIDA
- 2020: Electric Service Agreement formalizes SFPUC's role as Island's permanent electric service provider
- 2021: SFPUC energizes equipment in new switchyard
- 2023/2024: Stage 1 electrical distribution facilities accepted and energized in first two subphase area. Connected users become SFPUC utility customers

Evolution of SFPUC on-Island

- SFPUC supplies the electricity used by all residents and businesses on the islands.
- SFPUC has accepted ownership of new electrical infrastructure in the first two subphase areas. Properties in these areas are direct customers of the PUC Power Enterprise
- TIDA continues to contract with the SFPUC to operate and maintain the legacy electric and natural gas systems. For the legacy systems, the SFPUC:
 - Oversees operations of the systems
 - Performs ongoing maintenance, including repairs
 - Responds to and tracks interruptions and outages
 - Recommends system improvements subject to TIDA authorization and funding constraints

On-Island Power Infrastructure

- New facilities built out for SFPUC acceptance through development
- TIDA continues to own the legacy electrical. Properties in these areas are TIDA utility customers.

New SFPUC
Switchyard

Interim
Overhead
Lines

TIDA Legacy
Service Area

New SFPUC
Facilities and Service
Area

Stage II/III
Improvement
Area

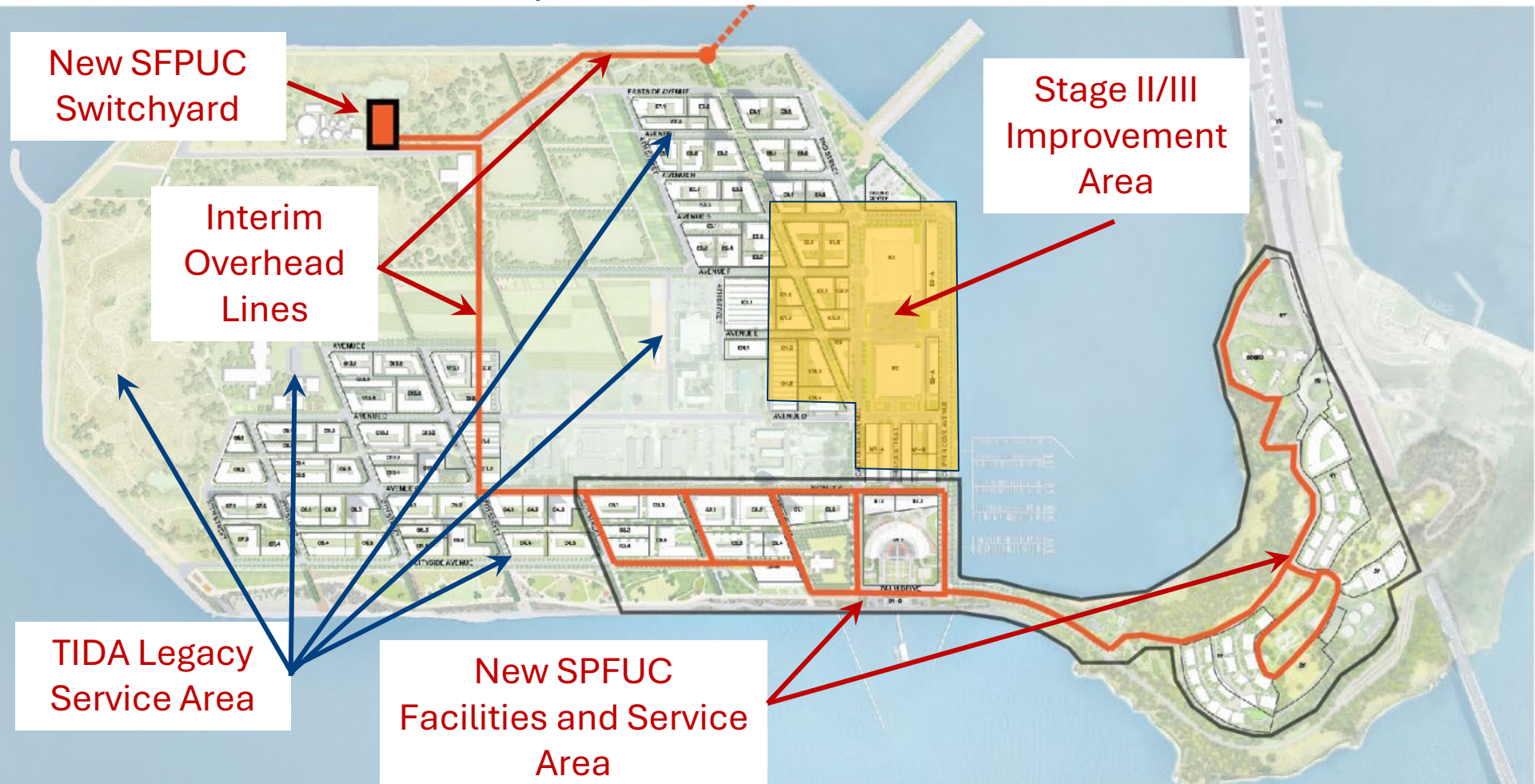

Legacy Electrical System Overview

- Electrical infrastructure has a typical lifespan of 25-30 years.
- Legacy Navy infrastructure on Treasure Island and Yerba Buena Island ranges in age from 40-50 years or more.
- TIDA has authorized a series of improvements to the Legacy electrical network in recent years.

Goal(s) of improvements:

- ✓ Increase system reliability
- ✓ Reduce the frequency and duration of outages
- ✓ Isolate outages to only part of the island reducing the area of impact
- ✓ Reduce the number of outages caused by temporary events like bird strikes or fallen tree limbs.
- ✓ Reduce time it takes to find the source of an outage, improving response time for power restoration



Legacy Electrical System - Completed Improvements (partial list)

New Electric "Express" Feeder

SFPUC Power recently improved legacy housing service reliability by constructing an express feeder connecting the legacy housing area to the TI switchyard; further isolating the housing area from the balance of the legacy system

Reinforce Gateview Circuits

SFPUC Power replaced parts of the legacy underground circuits on Gateview; which has been the source and area impacted by recent outages.

New Overhead Line

Installed and constructed a new overhead line from the switchyard in order to bypass legacy Building 3 switchgear to serve housing, increasing the reliability of the main line serving both islands



Legacy Electrical System – Ongoing Maintenance

Continuous Inspections

Perform continuous inspections to mitigate potential system failures and proactively identify and repair or replace damaged or aging components including transformers, fuses and cross-arms.

Review and Recommend

Identify additional improvement opportunities and make recommendations to TIDA.

Vegetation Management

Regular monitoring and trimming of trees on Treasure Island to maintain clearance around overhead lines and other infrastructure

Bird Guards

Consistently analyze overhead system bird strike events and install additional bird guards on vulnerable overhead lines

Total Outages by Year

Number of outages by year

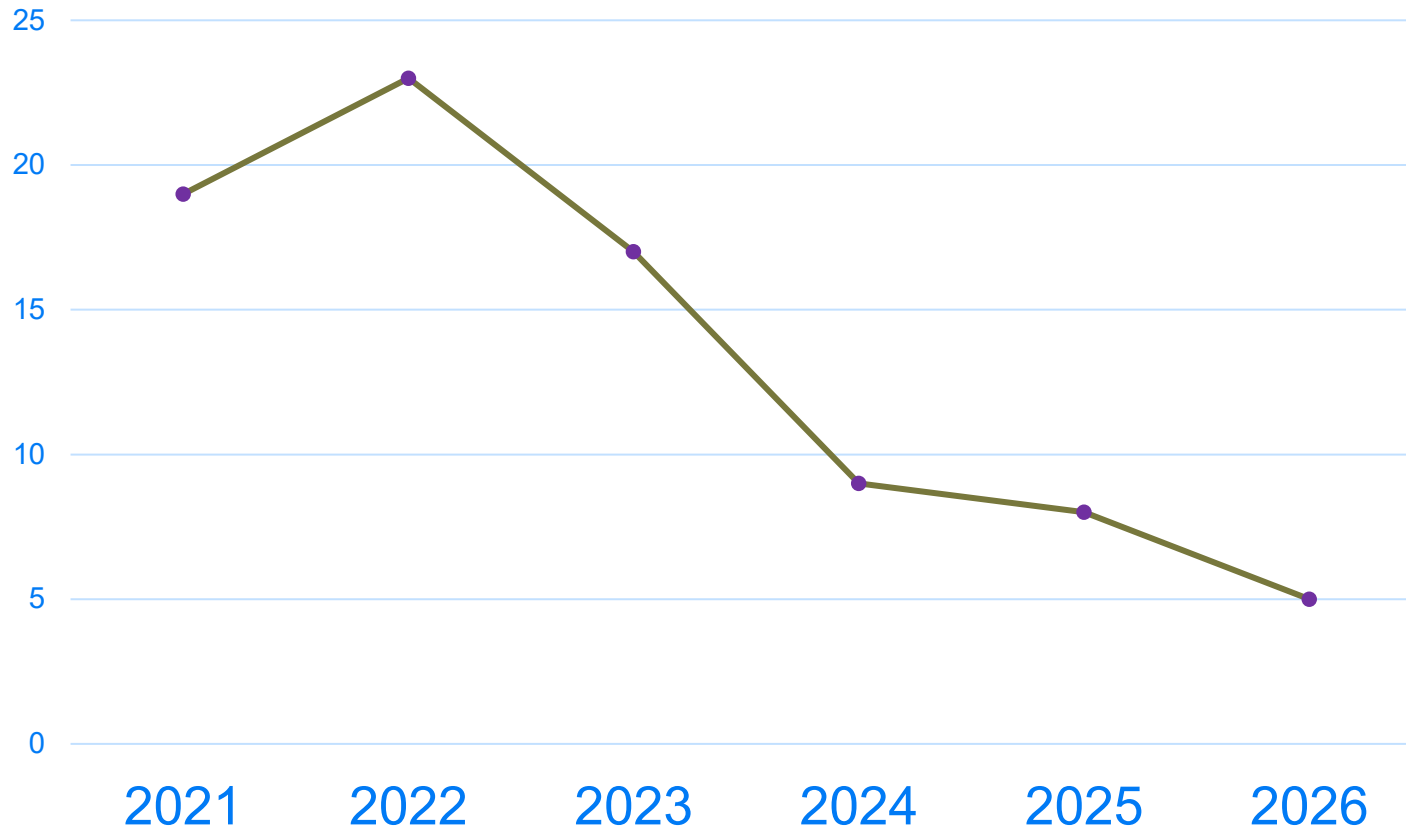

Outages have decreased in both frequency and number of effected customers

Permanent Electrical Progress – Stage 1

The new permanent switchyard facilities have stabilized system performance, isolating certain fault events, reducing impacts to the legacy residential neighborhood, and preventing island-wide outages.





Permanent Electrical Progress – Stage 1

Completed to date: June 2026

- New 12kv Switchyard
- New Wastewater Treatment Facility
- Phase 1 Stage 1 Electric Distribution Backbone
 - 974 Residential Units Total
 - 297 Affordable Housing Units
 - Commercial Buildings & Facilities
 - Municipal Buildings, Ferry Terminal, Parks, Pump Stations, etc.
- Facilities Connected to Stage 1 Interim Overhead System:
 - Bay FC
 - Glenn Soccer Field



Permanent Electrical Progress – Stages 2 and 3

In-Construction and Scheduled Work

- Stage 2 Electric Distribution Backbone – Construction start April 2026
- Stage 3 Electric Distribution Backbone – Currently in Permitting
- Current Scheduled Projects in Stages 2 and 3
 - 850 Residential Units Planned through 2028
 - 508 of those 850 units to be Affordable
 - Commercial Buildings & Facilities
 - Ferry Electrification / Electric Vehicle (EV) Charging
 - West Side Bridges
 - Parks



Permanent Electrical Progress– forward looking

- No Legacy System
 - Phase out all remaining legacy infrastructure to eliminate failure points.
- Underground Grid
 - New resilient underground infrastructure to eliminate bird strikes and weather-related failures.
- Resilience & DER (Distributed Energy Resources)
 - Infrastructure designed to support energy storage, microgrids, and local renewable generation.
- Advanced Monitoring
 - Smart grid deployment for real-time load balancing and proactive fault detection.

TI Legacy Natural Gas System

- 1997 Naval Station Treasure Island closes
 - City and Navy enter into caretaker agreement, including operating and maintaining utility infrastructure
 - Upon its formation, TIDA assumes caretaker responsibilities contracting with the SFPUC to operate utilities
- 2015 Navy transfers ownership of ~50% of the island to TIDA, including utilities on that property.
- 2016 New infrastructure construction and initial demolition of legacy natural gas infrastructure commences
- 2023 New PG&E natural gas distribution facilities in the first two subphases are pressurized

Natural Gas Supply to TI/YBI

- Natural gas delivered to Treasure Island through a PG&E-owned and operated submarine transmission line from the East Bay.
- The transmission line lands at a regulator station on Treasure Island, from which separate PG&E and TIDA distribution infrastructure serves the two different customer bases.

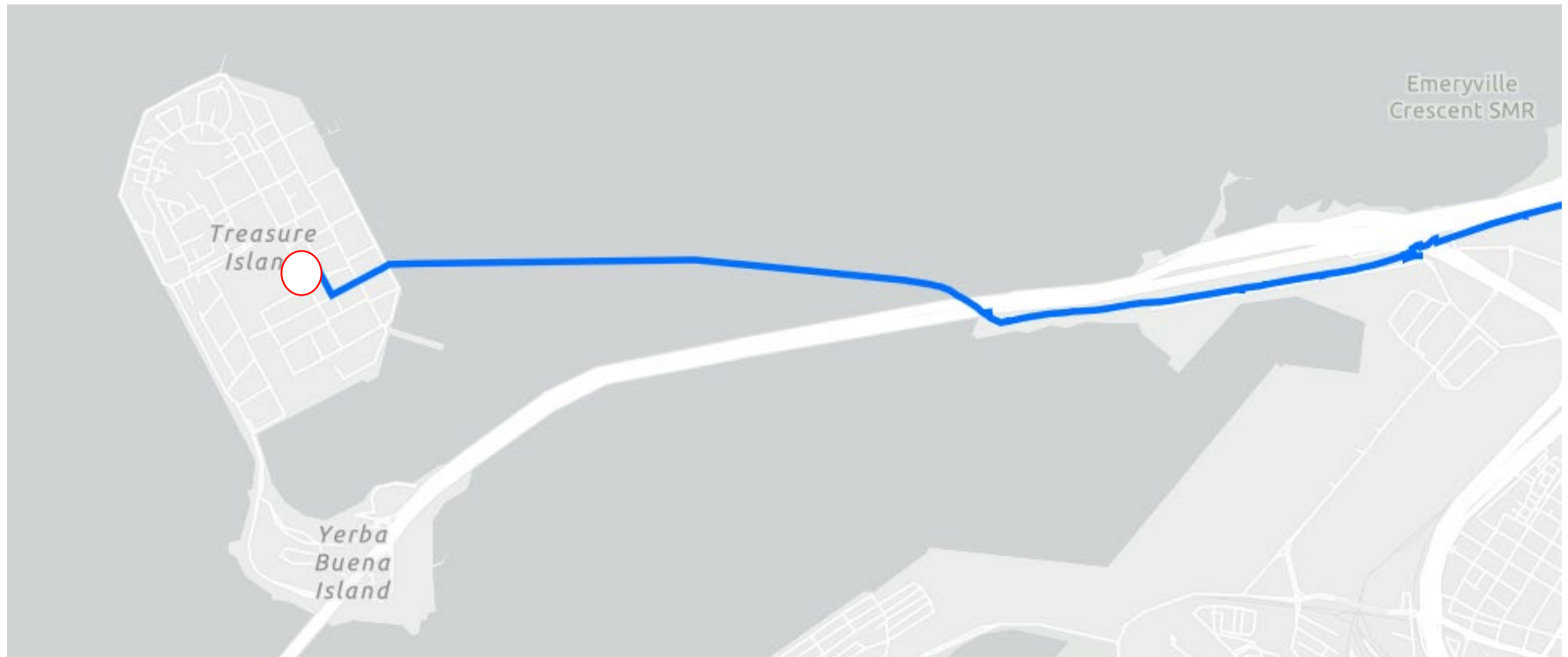

Natural Gas Distribution on TI/YBI

- PG&E infrastructure serves all newly constructed residential properties on TI/YBI as well as United States Coast Guard properties on YBI.
- TIDA owned/PUC operated infrastructure serves Treasure Island legacy properties with natural gas service:
 - Treasure Island legacy housing
 - Life Learning Academy
 - Treasure Island YMCA
 - SFFD Fire Station 48
 - TIDA Commercial properties
 - Building 33
 - Building 157
 - Treasure Island Job Corps

Legacy Natural Gas System Challenges

- Natural gas infrastructure has a typical lifespan of 25-30 years
- Legacy Navy infrastructure on Treasure Island and Yerba Buena Island ranges in age from 40-50 years or more
- Age and condition of lines and valves requires consistent monitoring and regular preventative maintenance. Architecture of the legacy distribution system poses challenges when minimizing/isolating outage areas.
- SFPUC focuses on assuring system safety, reliability and resiliency; minimizing potential for outages caused by equipment or line failures.



Ongoing Legacy Natural Gas System Maintenance

- **Install new residential neighborhood control valve**

Improved isolation of outage areas, maintaining service for more customers during planned and unplanned outages.

- **Isolate abandoned system segments and disconnect abandoned properties from system**

Purging segments of on-Island legacy system distribution line no longer serving customers and isolating abandoned buildings from the Island distribution system.

- **Comprehensive valve testing and replacement - Upcoming**

Upcoming comprehensive assessment and testing of legacy system valves, followed by any repairs or replacements identified by the process.

Ongoing Legacy Natural Gas System Maintenance

- **Continuous Inspections**
Perform continuous inspections to mitigate potential system failures and proactively identify and repair or replace damaged or aging components.
- **Review and Recommend**
Identify additional improvement opportunities and make recommendations to TIDA.



Sunsetting the TI legacy Natural Gas System

- Development plans call for permanent PG&E owned and operated natural gas distribution system.
- There are no new customers to be added to the legacy natural gas system.
- The legacy natural gas system service area will continue to shrink into the future as legacy residential move-outs continue and legacy commercial properties are demolished for development construction activity,
- The legacy system will be completely removed after the final natural-gas-served legacy property is permanently vacated.

TI Legacy Natural Gas System - through Development Phase 3

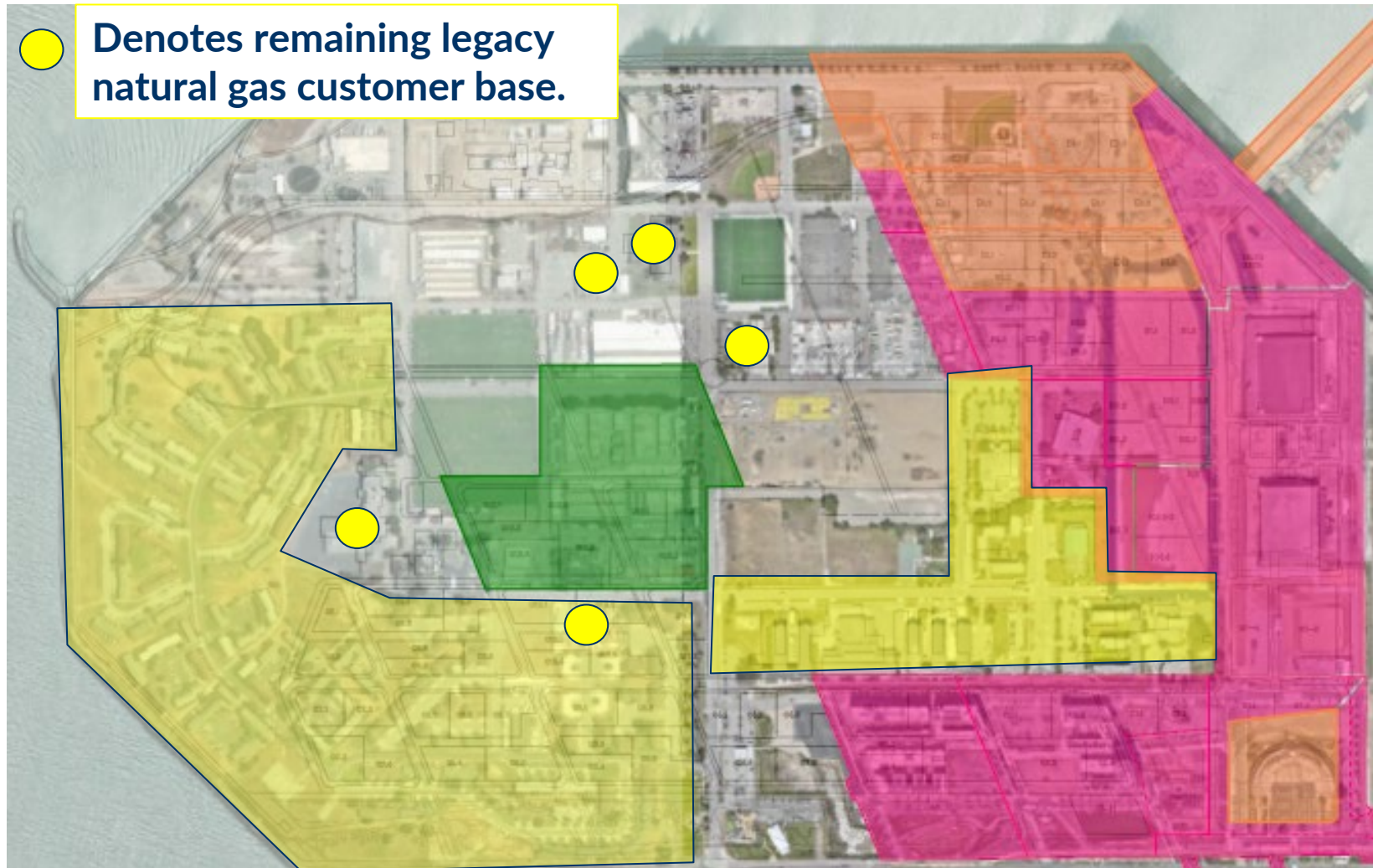

TI Legacy Natural Gas System – at Project completion

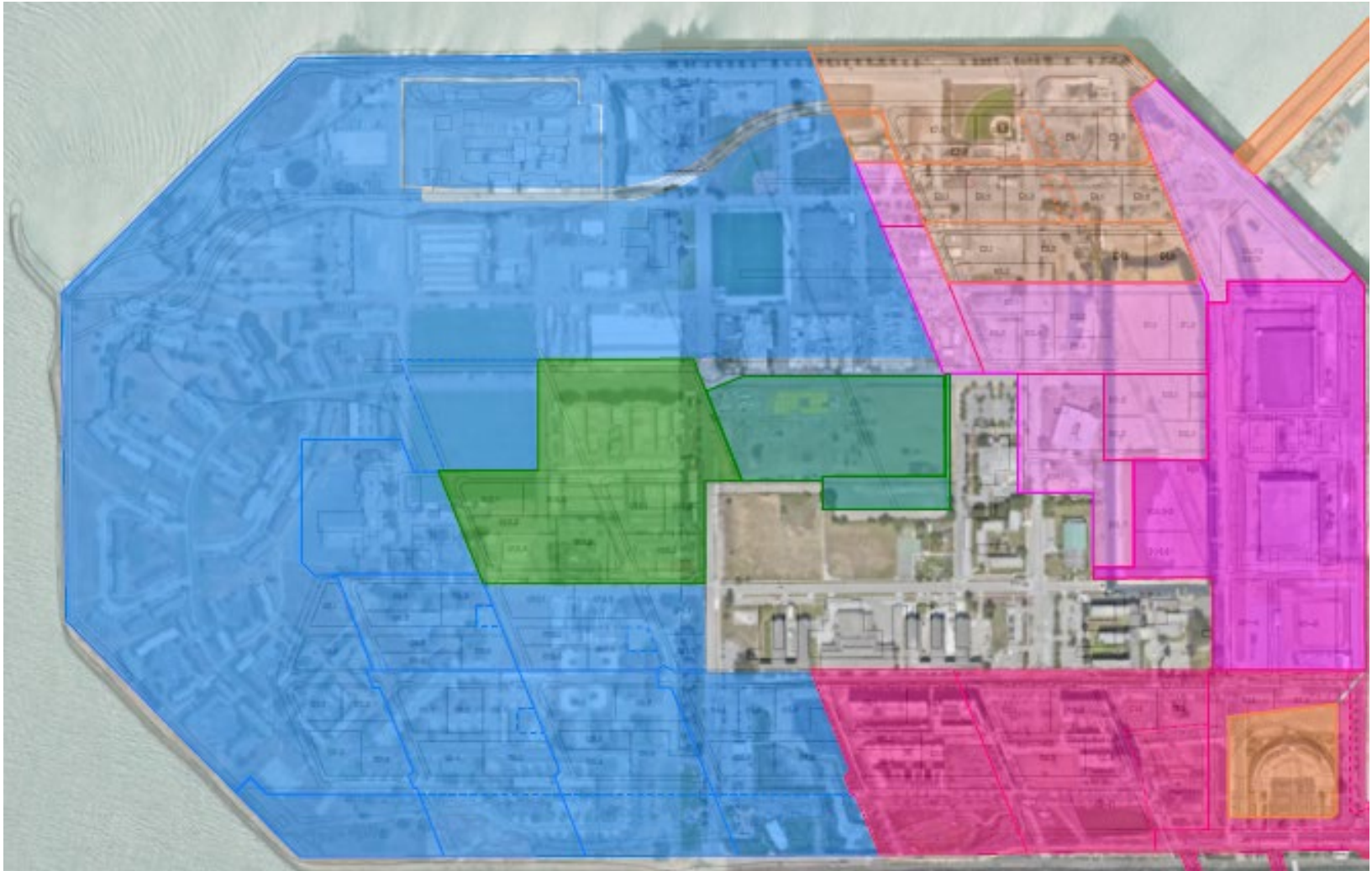

Permanent PG&E natural gas infrastructure - Current TI/YBI footprint

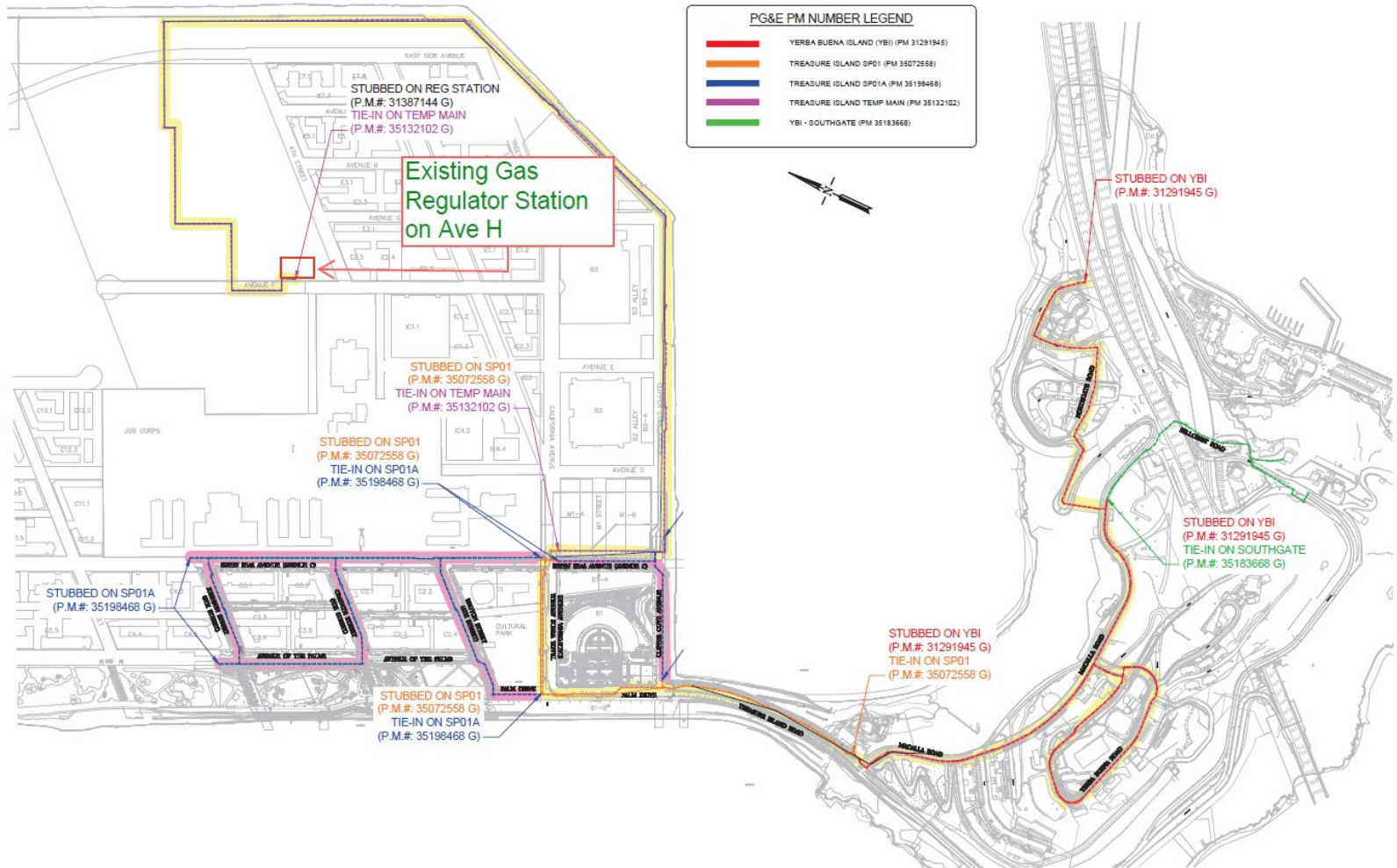

PRELIMINARY
NOT FOR CONSTRUCTION



Questions?

Chi Iao

Deputy Manager
Engineering and Field Operations
Power Enterprise
San Francisco Public Utilities Commission
ciao@sfgwater.org



Peter Summerville

Legacy Utility Operations
Treasure Island Development Authority
TIDA@sfgov.org

