

Moccasin
Materials Management
Warehouse
CDR Concept Phase
OCTOBER 2025



Services of the San Francisco Public Utilities Commission

PROJECT BACKGROUND

- MOCCASIN, CA
- LOCATED IN TUOLUMNE COUNTY, CA
- FOUNDED IN THE EARLY 1920S TO SUPPORT THE HETCH HETCHY WATER AND POWER SYSTEM
- HOME TO THE MOCCASIN POWERHOUSE, A GRAVITY FED HYDROELECTRIC POWER PLANT

- MOCCASIN POWERHOUSE BEGAN SERVICE IN 1925, AND WAS REPLACED IN 1969
- WATER FROM THE SIERRA NEVADA IS CONVERTED INTO ELECTRICITY FOR THE CITY OF SF
- WATER CONTINUES ON TO PROVIDE SF WITH CLEAN DRINKING WATER
- MATERIALS MANAGEMENT PROVIDES SUPPORT FOR THIS CRITICAL OPERATION

- MATERIALS MANAGEMENT'S CURRENT WAREHOUSE WAS BUILT IN 1966
- MULTI-LEVEL STEEL STRUCTURE
- SUPPORTS STORAGE, TOOLS, AND MAINTENANCE FOR HHWP
- MATERIALS MANAGEMENT HAS OUTGROWN THE CURRENT FACILITY.



O'SHAUGHNESSY DAM AND HETCH HETCHY RESERVOIR



OLD POWERHOUSE



EXISTING MATERIALS MANAGEMENT WAREHOUSE



MOCCASIN CAMPUS YARD AND PENSTOCKS

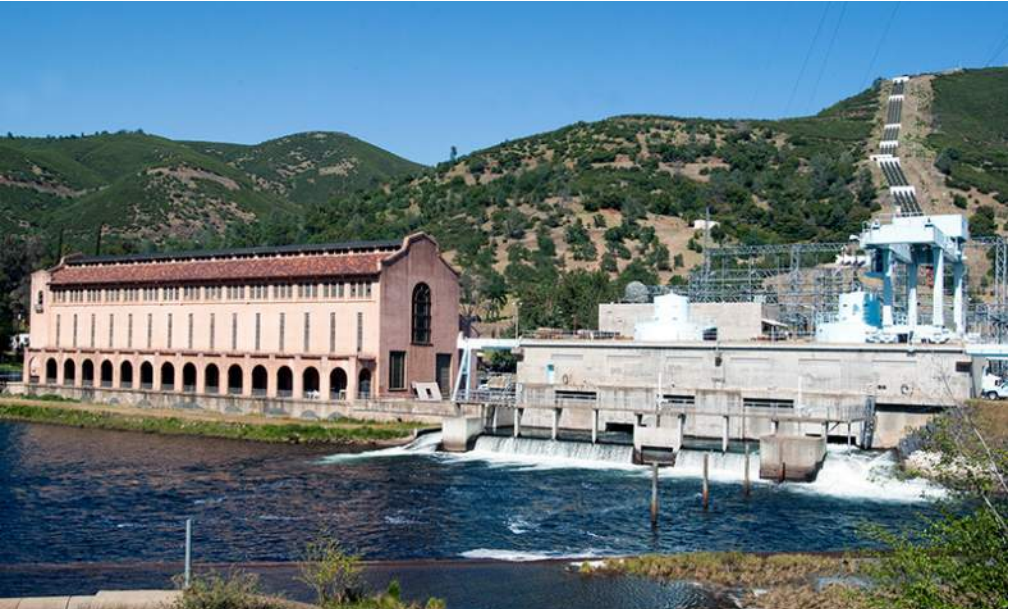

POWERHOUSES AND PENSTOCKS



BUILDING 76

CURRENT STORAGE CONDITIONS



EXISTING WAREHOUSE INTERIOR



SHELVES



PALLET RACKS



TOOL RACKS



DRY STORAGE



TIRE STORAGE



VERTICAL PIPE



OIL DRUMS



FLAMMABLE STORAGE



WIRE RACKS

REGIONAL CONTEXT

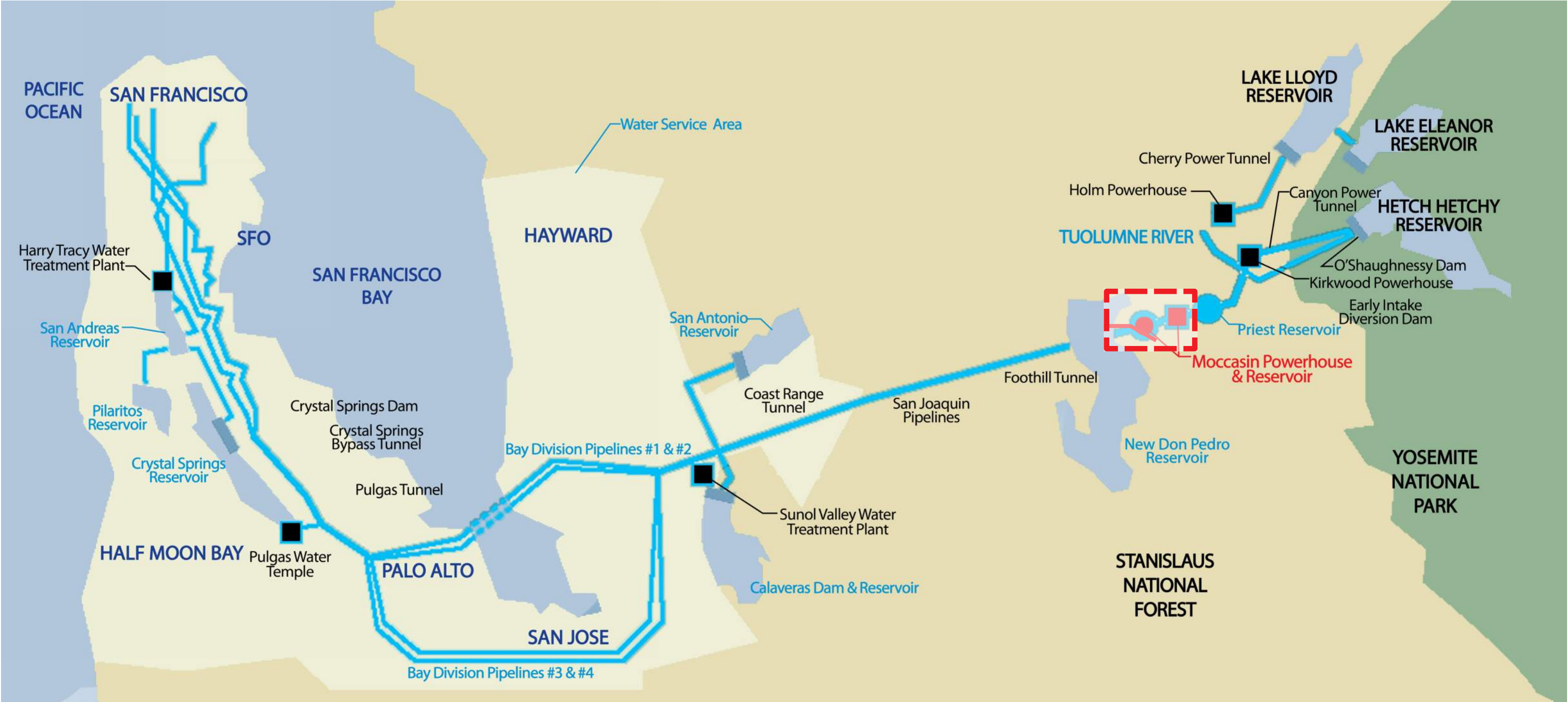

HETCH HETCHY REGIONAL WATER SYSTEM MAP

LOCAL CONTEXT AND SITE VIEWS



A LOOKING NORTHEAST AT BUILDING 76



B LOOKING NORTH TOWARD PROJECT SITE



C LOOKING AT BUILDING 76 FROM THE PROJECT SITE



D LOOKING SOUTH AT BOUNDARY RETAINING WALL



E LOOKING WEST TOWARDS MOCCASIN RESERVOIR



F LOOKING SOUTH WEST TOWARDS MODULAR OFFICES



G LOOKING NORTH AT SHOPS BEHIND BUILDING 76



H LOOKING SOUTH WEST

ARCHITECTURAL SITE PLAN EVOLUTION

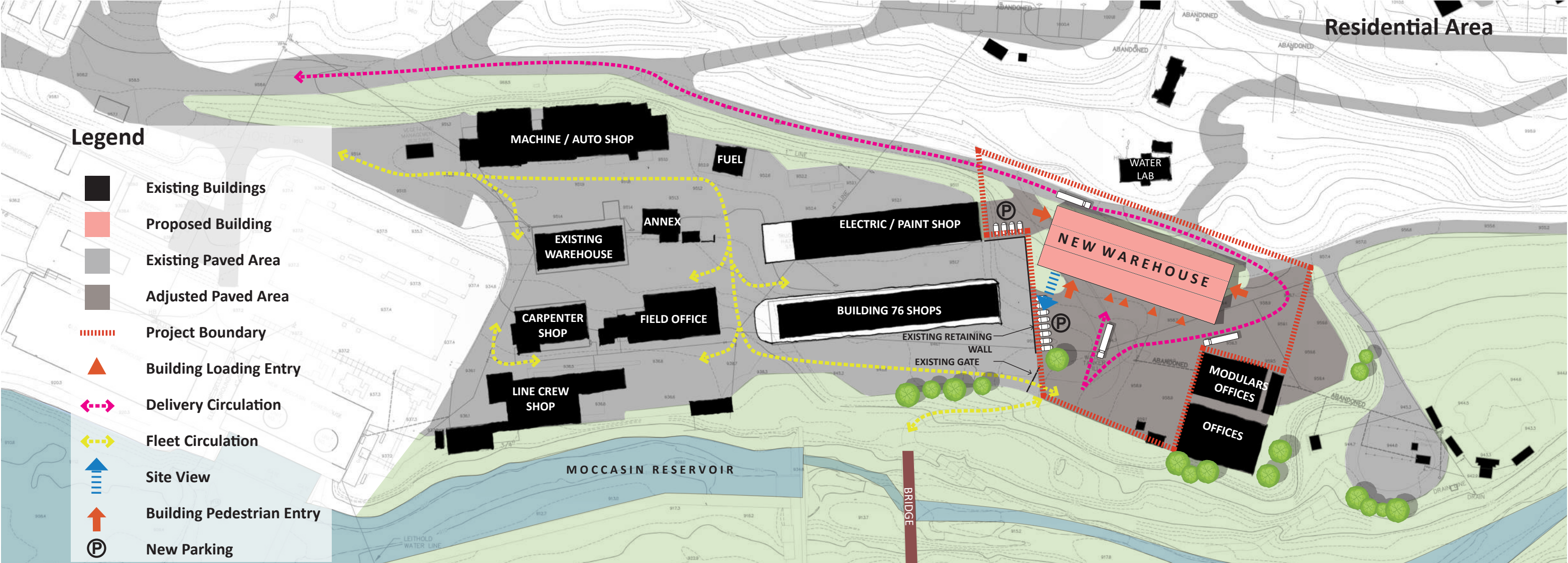

BUILDING SITE PLAN

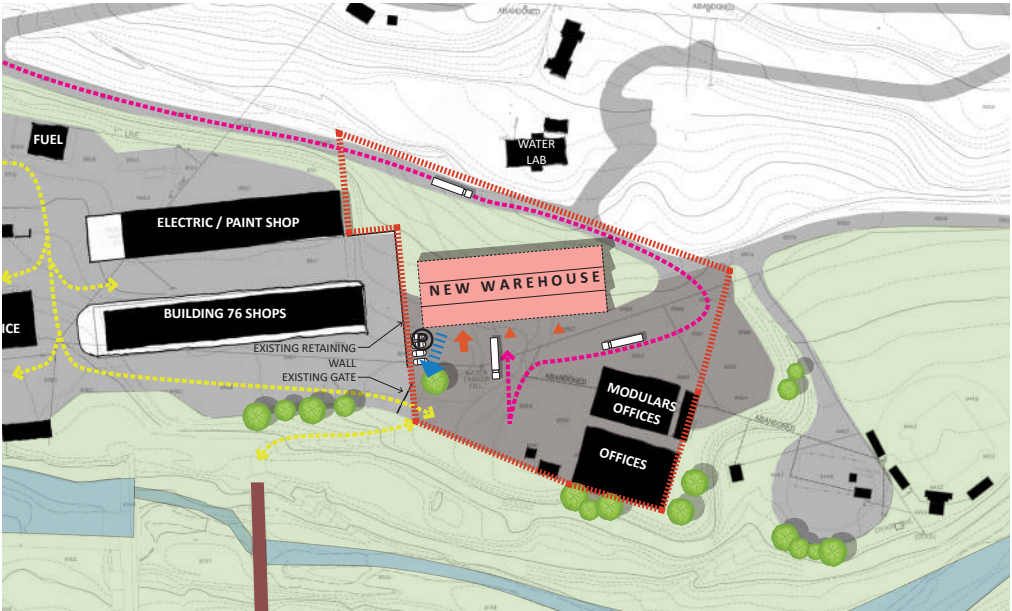

NOT TO SCALE

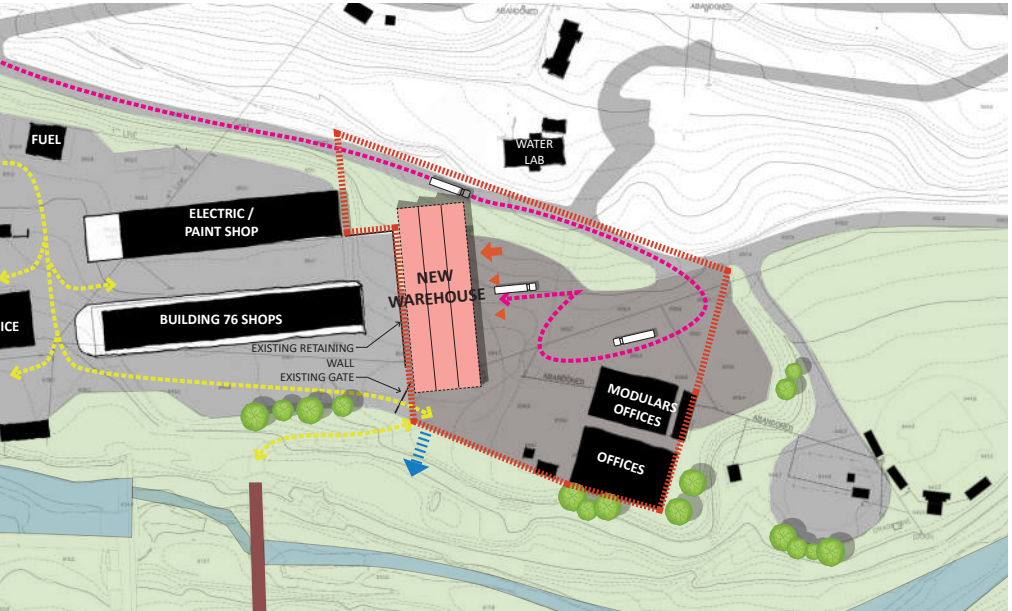

NOT TO SCALE

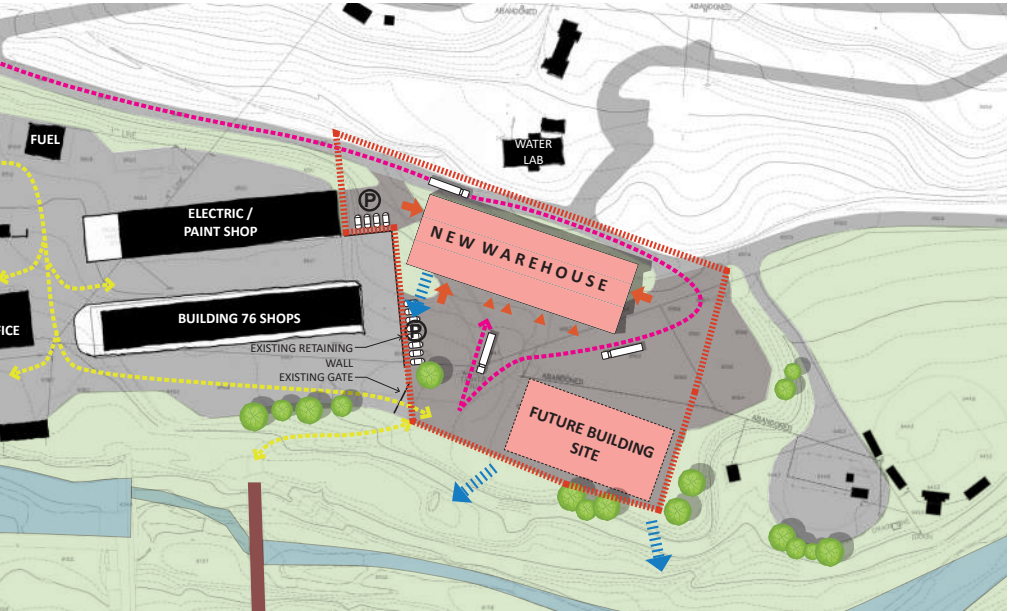

NOT TO SCALE

BUILDING PROGRAM ORGANIZATION

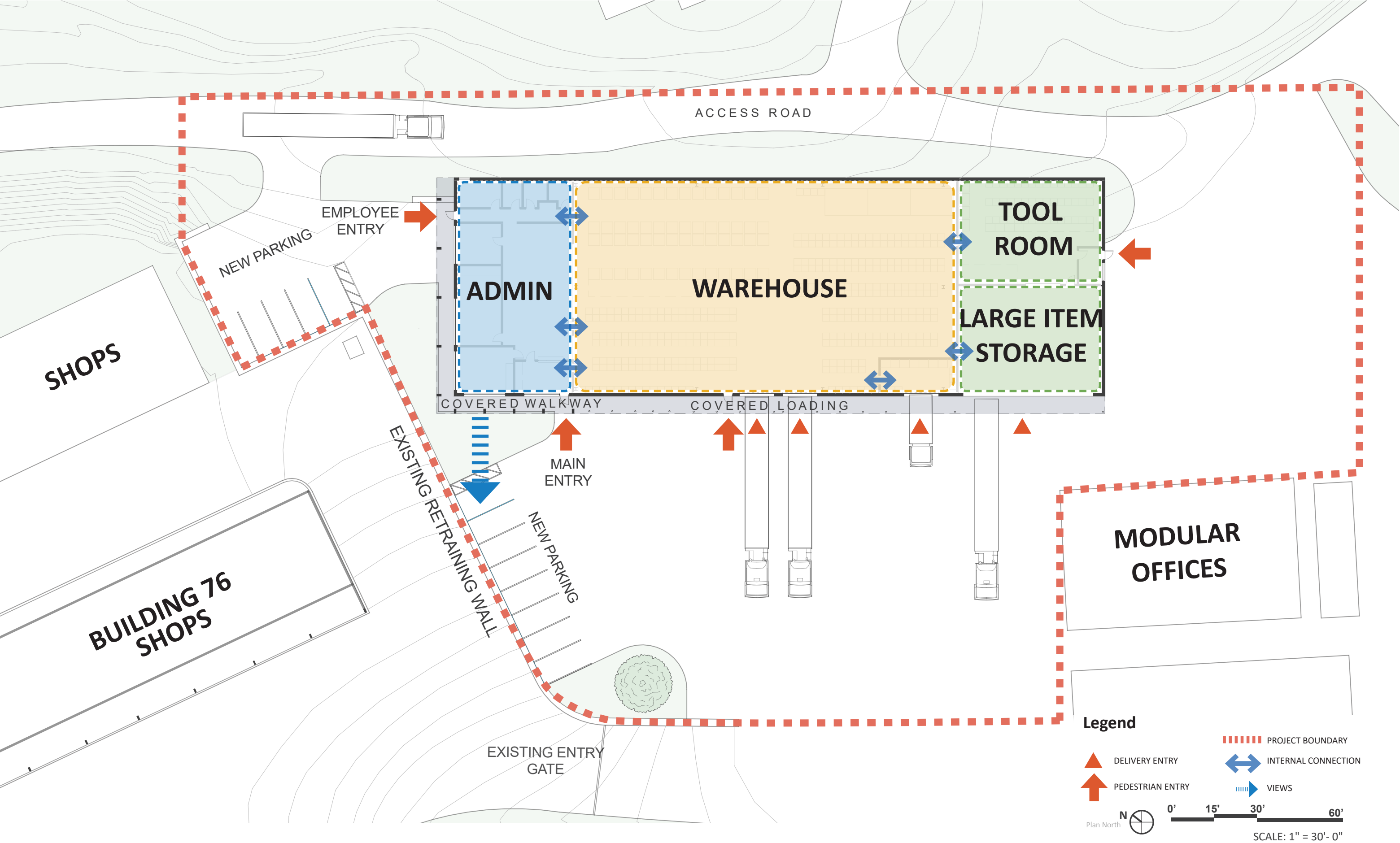

ARCHITECTURAL SITE AND BUILDING SECTIONS

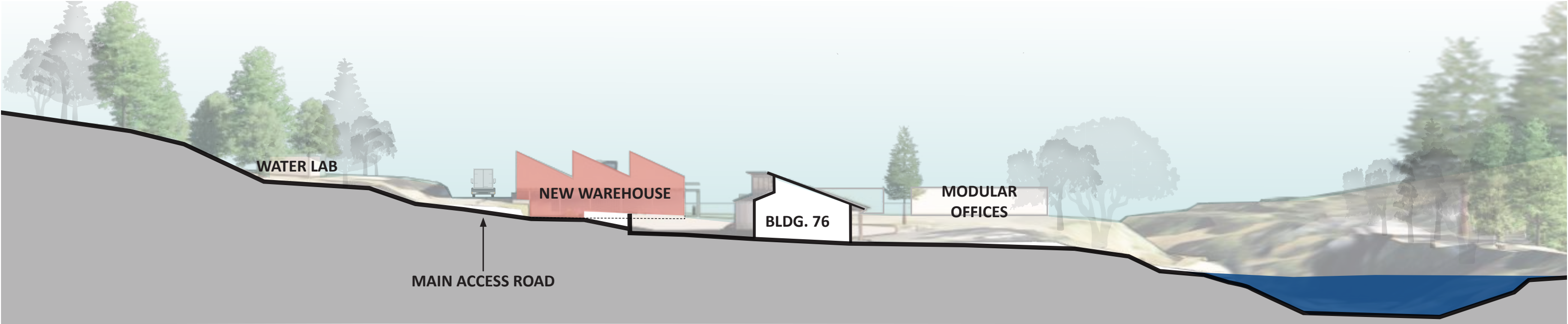

SITE SECTION

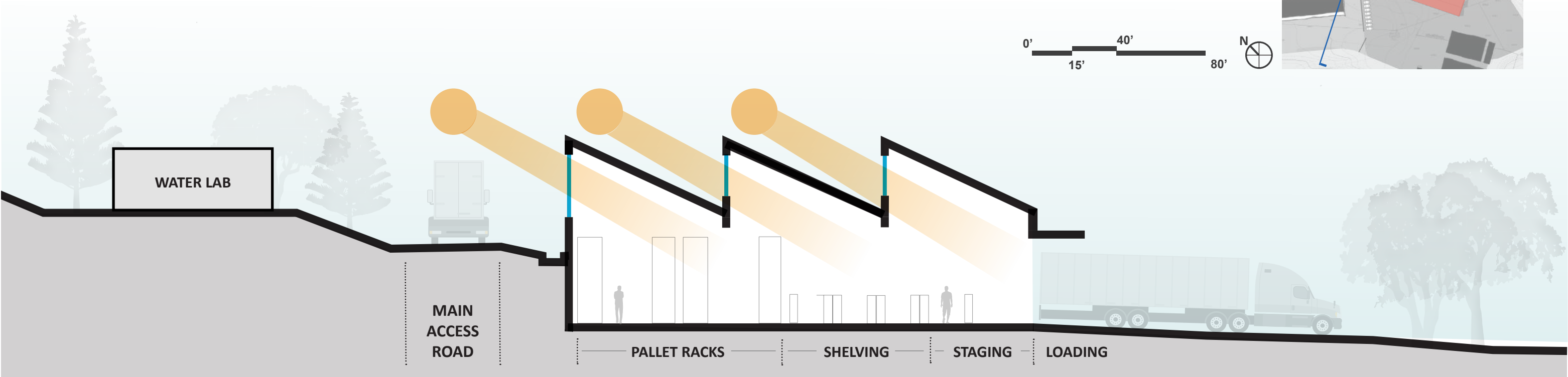

BUILDING SECTION

DESIGN PRINCIPLES

Aerial Perspective

- DURABLE, LOW-MAINTENANCE MATERIALS
- DIFFUSE NATURAL LIGHT TO ENHANCE WORK ENVIRONMENT
- SIMPLE MASSING FORMS AND EXPRESSED STRUCTURE

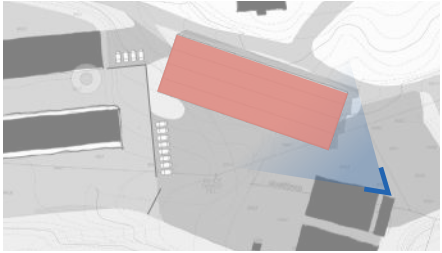

SIMPLE FORMS
CANNADY HALL, RICE UNIVERSITY
KARAMUK KUO

EXPRESSED STRUCTURE
UC BERKELEY ART MUSEUM & PACIFIC FILM ARCHIVE (BAMPFA)
DILLER, SCOFIDIO + RENFRO

NATURAL LIGHT TO ENHANCE WORK ENVIRONMENT
KIT ENERGY LAB
BEHNISCH ARCHITEKTEN

DESIGN PRINCIPLES

North Perspective

- BUILDING NESTLED INTO SLOPE FOR LOW VISUAL IMPACT
- MECHANICAL WELLS CONCEAL ROOFTOP UNITS, PRESERVING CLEAN ROOF LINE

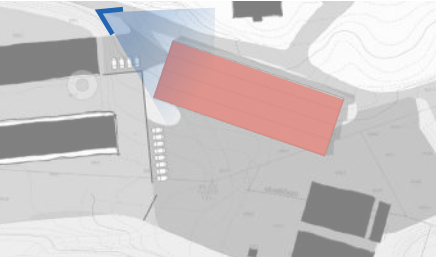

NATURAL LIGHT TO ENHANCE WORK ENVIRONMENT

VITSCÉ HEADQUARTERS, UK

VITSCÉ AND MARTIN FRANCIS



SIMPLE FORMS

CANNADY HALL, RICE UNIVERSITY, TEXAS

KARAMUK KUO



DURABLE, LOW MAINTENANCE MATERIALS

MULTIPURPOSE CENTRE, SPAIN

GUTIÉRREZ-DELA FUENTE ARQUITECTOS

DESIGN PRINCIPLES

West Perspective

- ONE-STORY LAYOUT SUPPORTS HORIZONTAL WORKFLOWS AND EMPLOYEE SAFETY
- CANOPIES MITIGATE HEAT GAIN AND PROVIDE SHELTERED WORK AREAS

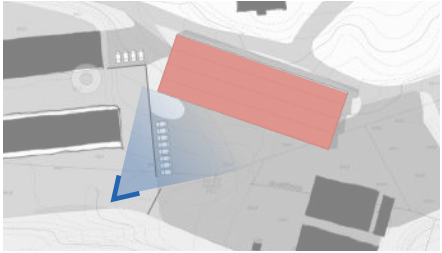

BLDG. 76

MOCCASIN WAREHOUSE



LOCAL TYPOLOGIES, SIMPLE FORMS

BUILDING 76

SAN FRANCISCO BUREAU OF ARCHITECTURE

NATURAL LIGHT TO ENHANCE WORK ENVIRONMENT

VITSØ HEADQUARTERS, UK

VITSØ AND MARTIN FRANCIS

DURABLE, LOW MAINTENANCE MATERIALS

KIT ENERGY LAB

BEHNISCH ARCHITEKTEN



Thank You

